



MTG 210-6

6V-210Ah - GEL Battery

APPLICATIONS

Electric Vehicles (EV)
Home Mobility Equipment (HME)
Cleaning Equipment
Solar Applications
All deep cycle applications

SPECIFICATIONS

Nominal Voltage			6V
80% DoD Voltage Cutoff			5.7V (1,90 VPC)
Nominal capacity @20 hour rate	1.75VPC	210Ah	
Capacity at 25°C	Capacity at 25°C	10 hour rate	198Ah
		5 hour rate	184Ah
Shelf time @20°C up to 70%		in months	12
Self discharge		per month	<3% (20°C)
Operating temperature for (dis)charge			-10°C to + 50°C

DIMENSIONS

Dimensions LxWxH (T) in mm	242 x 186 x 251 (274)
Weight	32kg (±2%)
Terminal	M8 insert
Terminal torque setting	n.a.
BCI-Group	DIN

CHARGING PROFILE (25°C in cyclic application)

IU Charging	I =	Min 20Amp / max. 30Amp
	U =	2.43 per cell
IUI Charging	I ¹ =	Min. 20Amp / max. 30Amp
	U =	2.38V per cell
	I ² =	Min. 2.5Amp (for max. 4 hours to max. 2.65V per cell)
Float-Voltage	U-float = 2,30VPC	
Temperature compensation is 3 mV per degree°C up or down from 25°C		

CYCLE LIFE

To maximize the cycle life of the battery, we recommend to charge the battery fully after use. The total life of the battery, is very dependant on the correct charge and depth of discharge per cycle.

FEATURES

- Maintenance-free bloc batteries in Gel technology
- Stable high current performance for extreme conditions
- High-class patented safety valve
- Valve-regulated lead-acid battery filled with thixotropic gel
- Classified as a non-spillable battery
- 700 cycles according to IEC 254-1 / DIN EN 60254-1

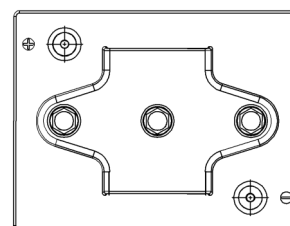
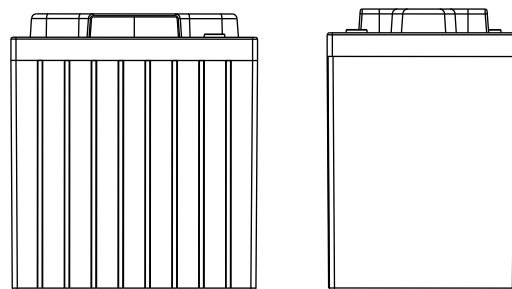

GEL Cycle Life vs Depth of Discharge at +25°C
Based on IEC 254-1

